

LEGEND	
EXISTING	PROPOSED
ROAD	ROAD
PROPERTY LINE	RIGHT-OF-WAY LINE
ABUTTERS PROPERTY LINE	EASEMENT
PROPERTY SETBACK	CL ALIGNMENT
100	100
101	101
BITUMINOUS PAVEMENT	GRAVEL
STORM DRAIN MANHOLE	SD
STORM DRAIN LINE	W
WATERLINE	HYDRANT
OVERHEAD UTILITY	UGU
UNDERGROUND UTILITY	UTILITY POLE
GUARD RAIL	GUARD RAIL
RIPRAP	RIPRAP

CUT AND FILL BREAKDOWN:

STOCKPILES ON-SITE AS OF 10/22/2020 PER DRONE FLIGHT
 TOTAL CUT: 30,100± CUBIC YARDS (ASSUMED REMOVED FROM SITE)

FIRE POND EXCAVATION
 TOTAL CUT: 50,670± CUBIC YARDS

SITE GRADING (DISREGARDING STOCKPILES)
 TOTAL CUT: 7,320± CUBIC YARDS
 TOTAL FILL: 17,360± CUBIC YARDS

TOTAL SITE CHANGES (STOCKPILES NOT INCLUDED)
 TOTAL CUT: 57,990± CUBIC YARDS
 TOTAL FILL: 17,360± CUBIC YARDS
 NET CUT: 40,630± CUBIC YARDS

ROAD CONSTRUCTION VOLUMES (NOT INCLUDED IN TOTAL SITE CALCULATIONS)
 1.5" OF 9.5MM PAVEMENT: 329 TONS
 2" OF 19.0MM PAVEMENT: 438 TONS
 3" OF TYPE "A" GRAVEL: 403 YARDS
 15" TYPE "D" GRAVEL: 2,014 YARDS
 COMMON BORROW IS BALANCED FOR ROAD CONSTRUCTION ALONE

LOAM FOR SITE: 14,500± YARDS (NOT INCLUDED IN TOTAL SITE CALCULATIONS)

FIRE POND VOLUME:

BOTTOM ELEVATION: 178.0
 BOTTOM AREA: 55,520 Sq. Ft.
 PERMANENT POOL ELEVATION: 187.0
 DRY HYDRANT PIPE ELEVATION: 180.6
 TOTAL POND VOLUME (EL. 176 - 187): 676,202 Cu. Ft.
 AVAILABLE VOLUME FOR HYDRANT (EL. 181.5 - 185): 271,724 Cu. Ft. or 2,032,637 GALLONS

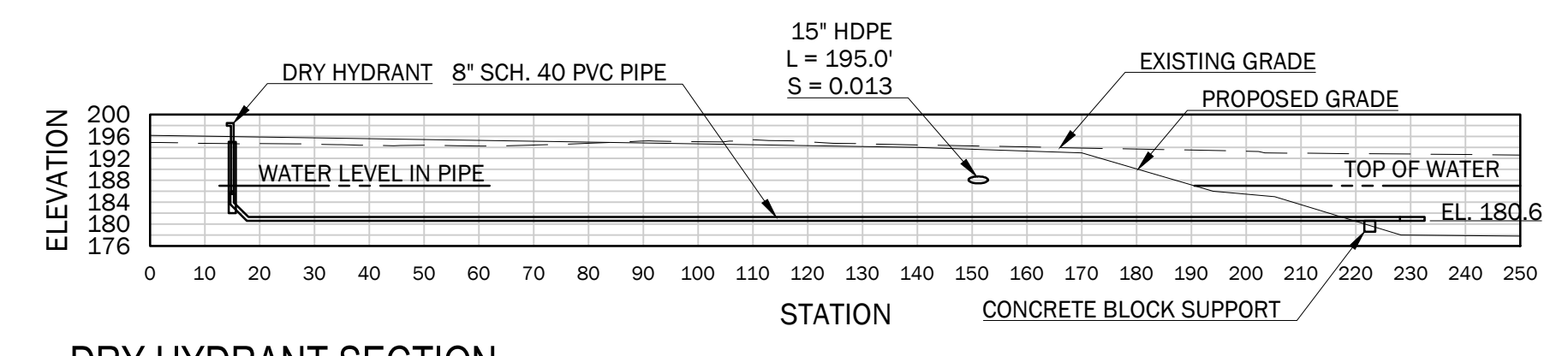
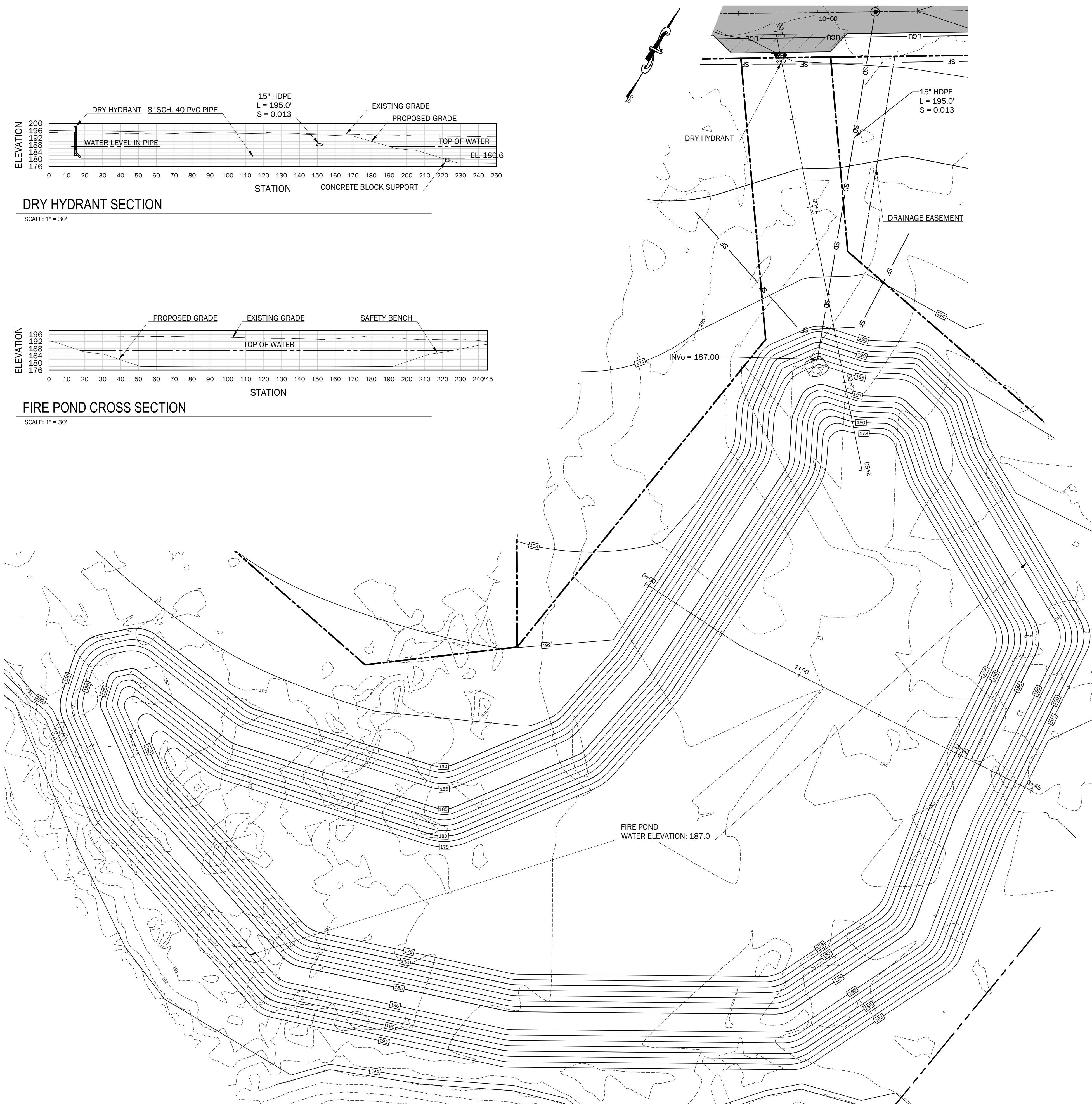

DRY HYDRANT SECTION
 SCALE: 1" = 30'

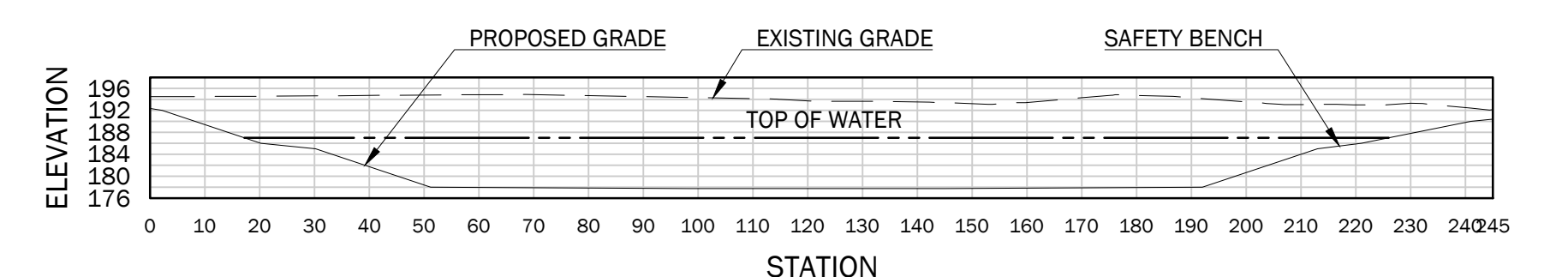

FIRE POND CROSS SECTION
 SCALE: 1" = 30'

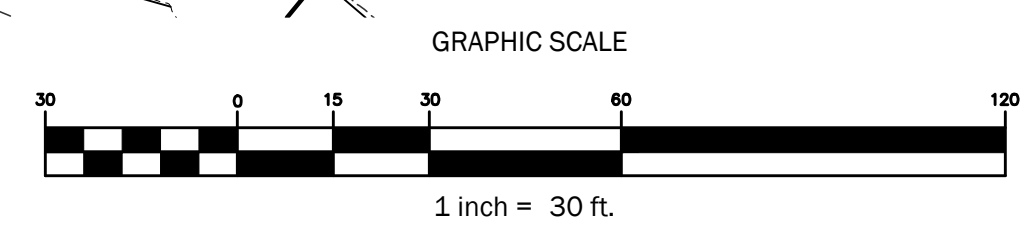

WALSH
 ENGINEERING ASSOCIATES, INC.
 One Karen Dr., Suite 2A | Westbrook, Maine 04092
 ph: 207.553.9898 | www.walsh-eng.com
 Copyright © 2021

PARKER RIDGE SUBDIVISION
 QUARRY ROAD
 PERRY OLIVER ROAD
 WELLS, MAINE
 PREPARED FOR:
TROY PARKER
 183 DROWNING ROAD
 ARUNDEL, MAINE 04048

ISSUED FOR PERMITTING - NOT FOR CONSTRUCTION

Rev.	Date	Description	Drawn	Check
1	3/24/2021	Updated LOB Lines, Relocated Drainage	JWG	NGC
2	5/14/2021	Updated per Town Comments	JWG	NGC
3	6/16/2021	Updated per Town Comments	JWG	NGC
4	10/22/2021	Added loam & road quantities	JWG	NGC

Sheet Title:
POND PLAN

Job No.: 676 Sheet No.:
 Date: MAR 18, 2020
 Scale: 1" = 30'
 Drawn: MTL/JWG
 Checked: NGC

C2.1