

Timber Harvest Planning Map of the Jeffery & Leisa Goodwin Lot
 185 Chick Crossing Road -- Wells, Maine
 Map 83 Lot 7
 Applicant: Parker Forestry Associates, LLC

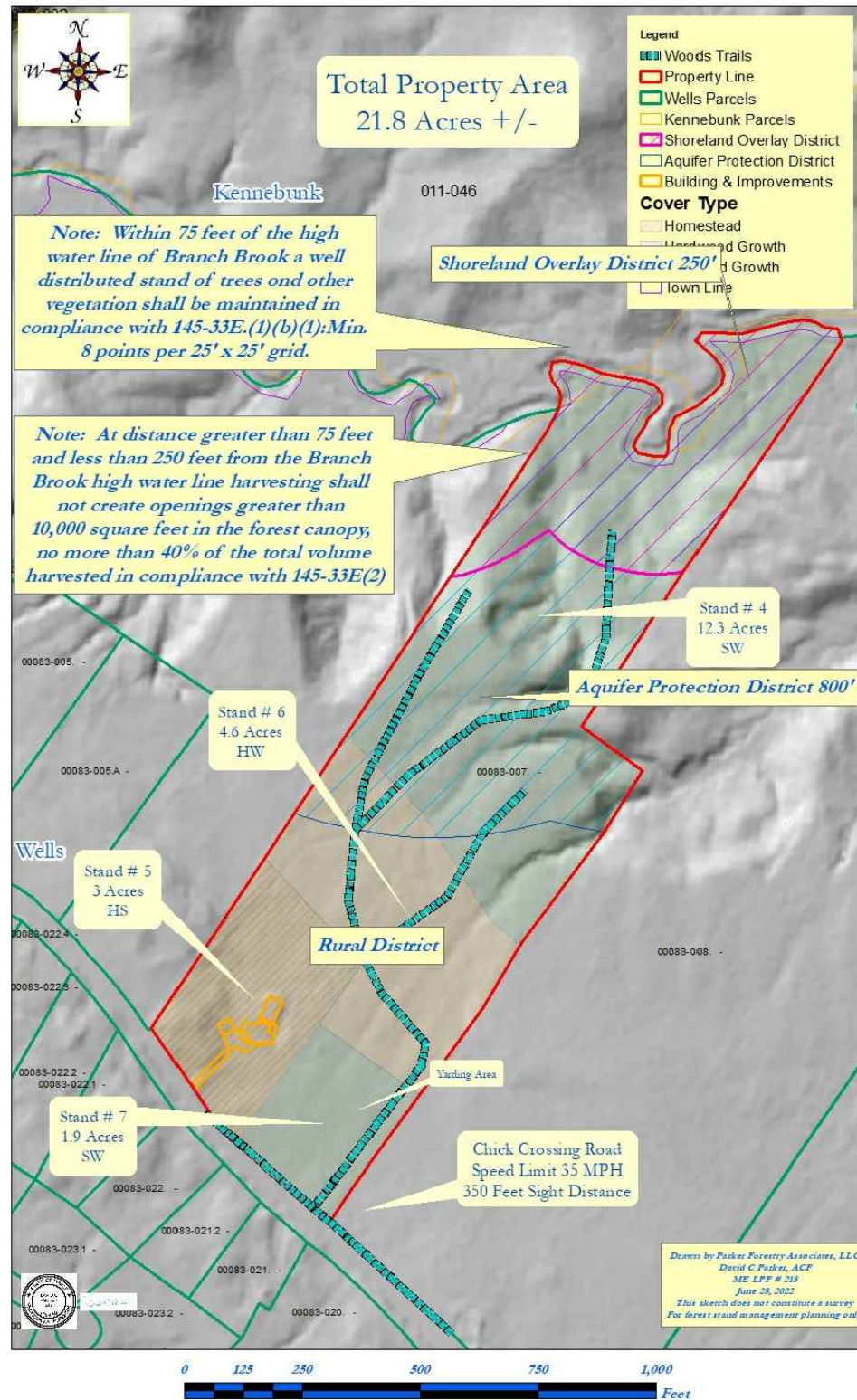

Wells code Section 145-31-A

Purpose. The purpose of the Aquifer Protection District is to protect and maintain the quantity and quality of the Branch Brook aquifer while allowing landowners a reasonable use of their property and a reasonable return from its development potential.

Wells code Section 145-31-G(3)

Timber harvesting within 250 feet of the high-water line of Branch Brook shall only be allowed as specified on a harvesting plan prepared by a registered professional forester and approved by the Planning Board. The Planning Board shall obtain review comments on any such plan from the Kennebunk, Kennebunkport and Wells Water District and the York County Soil and Water Conservation District.

Wells code Section 145-36

[Amended 4-19-1997]

If timber harvesting is deleted as a permitted use in a district, timber harvesting on a parcel of land in the Maine Tree Growth Program (36 M.R.S.A. §§ 571 to 584-A) shall continue as a permitted use as long as the subject lot, or portion thereof, remains in the Tree Growth Program.

Wells Planning Board Approval

Date _____

Notes:

1. The purpose of this plan is to obtain Planning Board approval to timber harvest within the Aquifer Protection District (145-31G(3)) and Shoreland Overlay District of Map 83, Lot 7. The property is located within the Rural, Aquifer Protection and 250' Shoreland Overlay District.
2. No lot coverage or structures proposed or exist in the AP or Shoreland Overlay zones.
3. Rural District & Aquifer Protection District Dimensional Requirements:
 - a. Setback requirements: 40' from lot line abutting state highway; 25' from lot line abutting a street ROW; 25' from the boundary of a cemetery; 25' from abutting lot lines; 200' from the high water line of Branch Brook.
 - b. Maximum lot coverage: 20%
 - c. Minimum street frontage: 200 feet
 - d. Minimum lot size: 100,000 SF net area (septic)
 - e. Maximum Density: 100,000 SF net area per dwelling (septic)
 - f. Maximum Building Height: 40 feet, not to exceed 3 stories
4. Shoreland Overlay District:
 - a. Shore frontage: 200 feet minimum (2,650' +/- provided)
 - b. Setbacks: 75 feet from high water line of Branch Brook
5. The use of pesticides is restricted within the AP zone per 145-31G(2).
6. Cutting and roads within the Shoreland Overlay zone are subject to the following requirements (145-33H(1 to 6)):
 - a. The 40% maximum volume of harvest will be complied with. The percentage of trees 4 inches or more in diameter to be harvested is 21.3%.
 - b. Existing woods roads are approximately 12' wide and are more than 75 ft from the high water mark of the brook. These roads were installed in the 1940's and 1950's and will not be modified during the harvest. The roads will be used as trails to operate tree skidding machines. No trucks, cars, or vehicles normally operated on public roads will be used on these roads.
 - c. The woods roads are not located on any slopes greater than 20%. Road grades are less than 10%.
 - d. The road banks are existing and will not be regarded or disturbed other than minor surface modification. Mulch will be applied where needed to secure scarified areas.
 - e. The road surfaces will continue to drain as they have for the past sixty plus years. No modifications of the road drainage will occur. No road cross drainages will be installed.
 - f. Buffers are satisfactory as all existing woods roads are outside of the 75 ft setback from the high water mark of Branch Brook. The trees will be cut and removed by a winch and cable on the skidder which will operate on the woods roads. Within 75 feet of the Branch Brook high water line a well-distributed stand of trees and other vegetation shall be maintained.
 - g. No flowing water crossing to be installed. No approaches to water crossings proposed or exist.
6. Timber harvesting operations to occur between daytime hours (7:00 am to approximately 5:00 PM).
7. The property shall comply with the Noise Ordinance requirements of 145.
8. No parking along or within Chick Crossing Road is permitted. Parking during the timber harvest shall be off-street and temporary, only during timber harvest operations.
9. Best Management Practices for soil erosion and sedimentation control shall be followed.
10. Two signs reading "trucks entering roadway ahead" will be placed on Chick Crossing Road east and west of the woodlot access road. These are temporary portable signs and will be removed at the conclusion of the harvesting operations.
11. See Findings of Fact & Decisions for all conditions approval associated with this plan approval.
12. Timber harvest shall be supervised by a Maine licensed professional forester.